



# LINEAR

OUTDOOR GAS BURNER SYSTEMS



THE ULTIMATE IN DESIGN, ENGINEERING & QUALITY

OB72MVN Linear Burner (Millivolt/Natural Gas), Z5GC Decorative Bronze Glass x6, RBCB1 Cannonballs (14 piece).





# LINEAR

OUTDOOR GAS BURNER SYSTEMS



OB24MVN Linear Burner – Millivolt – Natural Gas,  
Z5GC Decorative Bronze Glass x4, RBCB1 Cannonballs.

WHITE

YELLOW

RED

PURPLE

BLUE

GREEN

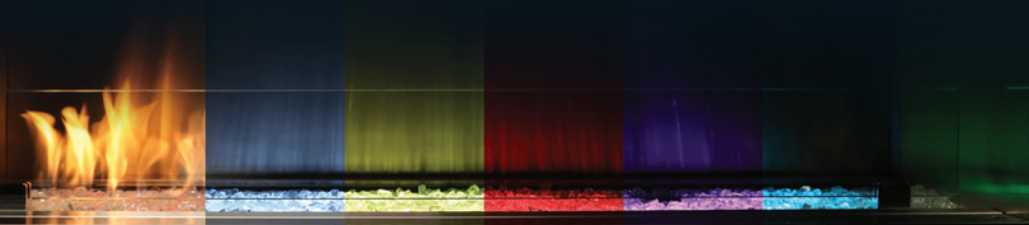

## OPTIONAL PF2 LED ACCENT LIGHTING

(for IPI PF2 models only).

Completely flexible, the Linear Outdoor Burner is the perfect project for do-it-yourselfers. Five sizes available (24, 36, 48, 72, 96") and for longer lengths simply link them together to create your own custom size!

Plus, adding decorative glass, cannonballs and wind guard options ensure you create the look you want. When you have achieved your desired look, invite family and friends to gather around for a perfect get together outdoors.



## REMOTE CONTROL

(for IPI PF2 models only).

Features flame height modulation and multi-color LED accent lighting control.



THE ULTIMATE IN DESIGN, ENGINEERING & QUALITY

# LINEAR

## OUTDOOR GAS BURNER SYSTEMS

24"

36"

48"

72"

96"

### OB24MVN/IPN

Natural Gas  
Millivolt/IPI PF2  
40,000 BTU

### Propane Conversion Kit

24OB-CKLP Millivolt  
24OB-CKLP2 IPI

### OB24MAPT\*

Propane  
41,000 BTU  
Manual Valve  
w/thermocouple

### Dimensions (A) x (B)

26"L x 7 1/2"W

### OB36MVN/IPN

Natural Gas  
Millivolt/IPI PF2  
60,000 BTU

### Propane Conversion Kit

36OB-CKLP Millivolt  
36OB-CKLP2 IPI

### OB36MAPT\*

Propane  
60,000 BTU  
Manual Valve  
w/thermocouple

### Dimensions (A) x (B)

38"L x 7 1/2"W

### OB48MVN/IPN

Natural Gas  
Millivolt/IPI PF2  
80,000 BTU

### Propane Conversion Kit

48OB-CKLP Millivolt  
48OB-CKLP2 IPI

### OB48MAPT\*

Propane  
60,500 BTU  
Manual Valve  
w/thermocouple

### Dimensions (A) x (B)

50"L x 7 1/2"W

### OB72MVN

Natural Gas  
Millivolt Only  
120,000 BTU

### Propane Conversion Kit

72OB-CKLP Millivolt

\* Manual Valve Systems (MAPT) are shipped as Propane, NG conversion orifice is included with burner.

### Dimensions (A) x (B)

74"L x 7 1/2"W

### OB96MVN

Natural Gas  
Millivolt Only  
156,000 BTU

### Propane Conversion Kit

96OB-CKLP Millivolt

### Dimensions (A) x (B)

98"L x 7 1/2"W

## GLASS MEDIA

REQUIRED: 5 lbs per foot of burner (ie: 24" burner = 10 lbs)



1/2" Bronze (5 lbs)

## CANNONBALLS

OPTIONAL



Assorted sizes and colors (14 pc)

## WIND GUARDS

RECOMMENDED: for outdoor burners (4 pc)

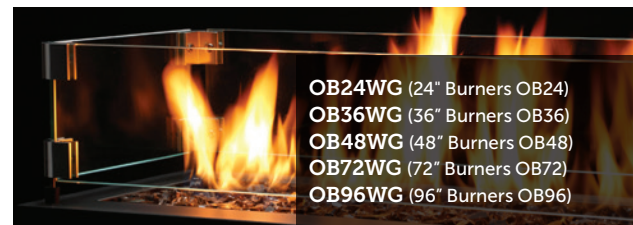

OB24WG (24" Burners OB24)  
OB36WG (36" Burners OB36)  
OB48WG (48" Burners OB48)  
OB72WG (72" Burners OB72)  
OB96WG (96" Burners OB96)

5 1/2" Height

### Top View



### Side View

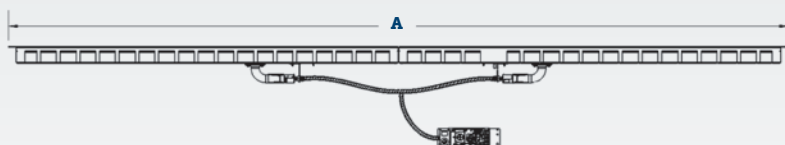

All burners are manufactured with Satin Coat steel with a high temperature black paint finish. Satin Coat steel is pretreated with a Zinc coating for corrosion resistance and paint adhesion.

### End View

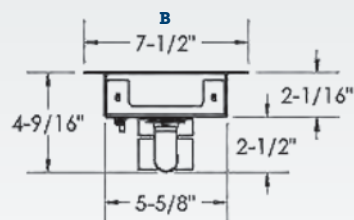





2340 Logan Avenue  
Winnipeg, Manitoba, Canada R2R 2V3  
Phone: (204) 632-1962 Fax: (204) 632-1960  
[www.kingsmanfireplaces.com](http://www.kingsmanfireplaces.com)

# LINEAR

## OUTDOOR GAS BURNER SYSTEMS



OB48MVN Linear Burner – Millivolt – Natural Gas,  
Z5GC Decorative Bronze Glass x4, OB48WG Wind Guard.



\*Components may have to be ordered separately to create a complete unit. Discuss with your local Kingsman dealer for clarification. Kingsman Fireplaces maintains a program of continuous testing, refinement and improvements of all its products. Some aspect of units shown here may be changed at any time without notice or obligation. Certified for USA and Canada ANSI Z21.97-2014, CSA 2.41-2014, Outdoor Decorative Gas Appliances.



CRAFTED ENTIRELY IN CANADA, EACH KINGSMAN BURNER  
IS BUILT TO THE HIGHEST STANDARDS AND MADE TO LAST.

Printed in Canada  
05/2023 – B101



### FOR CALIFORNIA RESIDENTS ONLY: **WARNING!**

This product can expose you to chemicals including Carbon Monoxide, that is an externally vented by-product of fuel consumption, which is [are] known to the State of California to cause birth defects or other reproductive harm. For more information, visit [www.P65Warnings.ca.gov](http://www.P65Warnings.ca.gov).